



# Installation Instructions

LoPro™  
Series



If you have any questions or concerns, *please call 1-800-473-3683*



## BEFORE YOU BEGIN

*Read these instructions completely and carefully*

- **Note to installer** – Be sure to leave these instructions for the consumer’s use
- **Note to consumer** – Keep these instructions with your Owner’s Manual for future reference
- **Skill level** – Installation of these teeth requires basic mechanical skills. Proper installation is the responsibility of the installer. Product failure due to improper installation is not covered under any warranty

**IMPORTANT** - Before you continue, please check the packing list to make sure it matches the contents of the boxes.



## Disconnect Power

to machine to prevent cutting wheel from rotating before proceeding. Failure to do so could result in death or serious injury.

**FOR YOUR SAFETY** read and observe all **CAUTIONS** and **WARNINGS** shown throughout these instructions. While performing installations described in this booklet, gloves & safety glasses or goggles should be worn at all times.

## Installation Preparation

### TOOLS SUPPLIED:

½" Drive, ½" 6pt Impact Allen Wrench Socket

### TOOLS YOU WILL NEED:

<i>500 Series Greenteeth® Red/Green</i>	<i>700 Series Greenteeth® Wearsharp™</i>	<i>700 Series Greenteeth® Red/Green</i>	<i>900 Series Greenteeth® Red/Green</i>
1/2" Socket Wrench	1/2" Socket Wrench	9/16" Socket Wrench	5/8" Socket Wrench

½" Drive Torque Wrench

Wire Brush

**Green-Seize™**

### TORQUE SETTINGS:

<i>500 Series Nut Red/Green</i>	<i>700 Series Nut Wearsharp™</i>	<i>700 Series Nut Red/Green</i>	<i>900 Series Nut Red/Green</i>
20ft. lbs. (27 Nm)	20ft. lbs. (27 Nm)	25ft. lbs. (34 Nm)	35ft. lbs. (47 Nm)

**LoPro™** Bolt (lubricated with **Green-Seize™**): 180ft. lbs.

**LoPro™** Bolt (dry): 240ft. lbs.

Green Manufacturing, Inc.  
9650 Packard Rd  
Morenci, MI 49256  
Phone 800.473.3683 • Fax 517.458.1550



# Greenteeth® LoPro™ Installation Instructions

*Here are some tips to guide you through the installation process.*

1. Locate the pocket set with reverse (over center) pockets on your wheel. If you don't use reverse (over center) pockets, locate the straight pocket sets.
2. Remove one set of reverse (over center) or straight pockets.
3. Using a wire brush, clean both sides of the wheel where it will come in contact with the pockets. Be sure to remove all dirt and debris so the pocket is seated tightly against the wheel.
4. Apply **Green-Seize™** to the threaded end of two **LoPro™** bolts.

5. Starting with the reverse (over center) or straight pocket install a **LoPro™** bolt into the counter-bored hole and then do the same of adjacent pocket of that set.

6. Slide the **LoPro™** bolts through the empty holes in the wheel and thread them into the adjacent pocket's threaded holes. For now, firm up the **LoPro™** bolts until pockets are seated. (Figure 1.1)

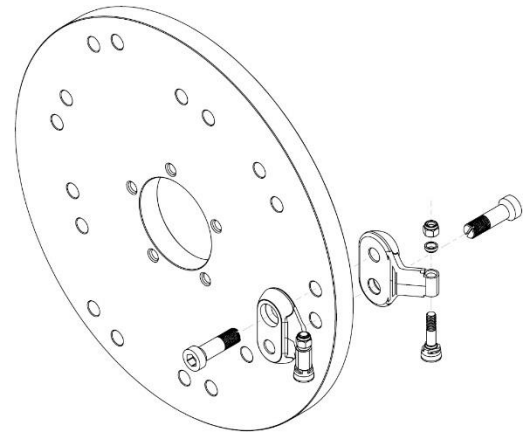

Figure 1.1

7. Rotate the wheel until you come to the next set of reverse (over center) or straight pockets. Repeat steps 2 – 6 until all reverse (over center) and/or straight pockets are installed.

8. Now it is just a matter of replacing standard angle pockets (angle occurs away from the wheel). You can do this by removing one set at a time or removing all the old standard angle pockets at once then repeat steps 2 – 6 for the angle pocket sets.

9. Install your teeth with the carbide facing down. The shoulder of the tooth will meet the flat indent of the pocket and the tooth will not rotate. Insert the spacer over the shank, with the chamfer down, then thread one of the lock nuts onto the top portion of the tooth. Hand tightening is good for now. Repeat until all teeth are installed. (Figure 1.2)

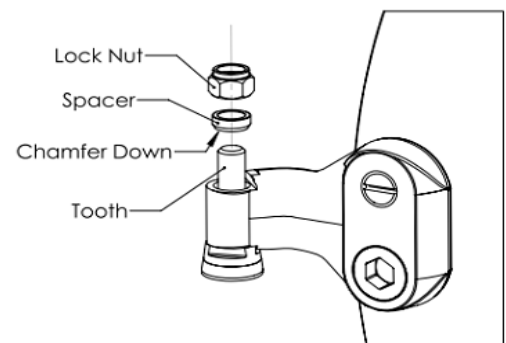

Figure 1.2

10. Make sure the pockets are seated on the wheel and the bolts are seated in the pockets. Continue tightening your **LoPro™** bolts until they are all torqued to 180ft. lbs. (240ft. lbs., if you didn't use any anti-seize)

11. Before torquing your tooth down, first make sure that the tooth is seated properly in the pocket. Then tighten the top nut until the tooth is firmly seated and torqued to the appropriate specification for the series; 500 - 20 ft. lbs. (27 Nm), 700 - 25 ft. lbs. (34 Nm), or 900 - 35 ft. lbs. (47 Nm). You may need to hold the tooth in place. Repeat until all teeth are properly torqued.



*Over-tightening the nut will stretch the threads and degrade the fasteners ability to retain the tooth.*

12. Once all pockets and teeth are torqued properly manually rotate the cutter wheel to ensure there is adequate clearance for the newly installed setup. If any teeth are rubbing or hitting on any part of the machine, do not proceed further. Remove the obstructed tooth/teeth and call Green Manufacturing, Inc. right away.
13. If determined that there are no obstructions, start the machine engine and engage the wheel.
14. Ensure there are no unusual noises emanating from the machine.

Please note that all fasteners, whether they are nuts or bolts, will loosen up from time to time due to vibration. Be diligent and check your bolts weekly.

If you dull or damage a cutting edge, you can rotate your tooth by following these steps:

- Loosen the nut with a standard wrench
- Tap the tooth down
- Rotate the tooth a third of a turn
- Reposition the tooth in its seat
- Retighten the nut to the proper torque specifications

## **GREENTEETH® GUARANTEE**

If you purchase a **Greenteeth**® setup and are not completely satisfied with its performance, please contact Green Manufacturing at 800.473.3683 to request a return authorization within 30 days of purchase date for a product refund or exchange.

### **WARRANTY:**

If you are not completely satisfied with your purchase, please contact Green Manufacturing, Inc. at 800.473.3683 to request a return authorization within 30 days of purchase date for a product refund or exchange. We strive to provide exceptional quality products. Our products undergo a stringent quality control process, however if you feel that there is an issue with the quality of your product, please contact Green Manufacturing, Inc. immediately. We will accept unused parts for return or exchange for up to 30 days from the date of purchase with proof of purchase included with the return.

Seller's warranties against defects and non-conformities and defects shall continue to apply only so long as the Goods: (i) have been installed, maintained and used in conformity with instructions furnished by Seller from time to time, if any, and otherwise in conformity with the highest industry practices; (ii) have been subjected to normal use for the purpose for which the Goods were designed; (iii) have not been subjected to misuse, negligence or accident; (iv) have not been altered or repaired by persons other than Seller or Seller authorized warranty service providers in any respect which, in the judgment of Seller, adversely affects the condition or operation of the Goods; and (v) have been fully paid for. IN NO EVENT SHALL SELLER BE LIABLE FOR ANY SPECIAL, INDIRECT, EXEMPLARY, INCIDENTAL, CONSEQUENTIAL, OR PUNITIVE LOSSES OR DAMAGES (INCLUDING, WITHOUT LIMITATION, BUSINESS INTERRUPTION, REVENUE OR PROFITS, FEES OR FINES), EVEN IF SELLER HAS BEEN ADVISED OR MADE AWARE OF THE POSSIBILITY OF ANY SUCH LOSSES OR DAMAGES AND REGARDLESS OF WHETHER THE CLAIM IS BASED ON CONTRACT, TORT, STRICT LIABILITY, OR OTHER THEORY OF LIABILITY. Seller's cumulative liability for all losses and damages under these General Terms and Conditions or under any of the Related Agreements (including, without limitation, those arising out of contract tort (including negligence), strict liability, warranty, or other theory of liability) shall not exceed (a) in the case of any services provided or to be provided by Seller, the amount of the fees payable by Buyer for such services under the applicable Related Agreement, and (b) in the case of any products or devices provided or to be provided by Seller, the amount of Seller's labor services associated with the product sale. Seller reserves the right to make, without notice to Buyer, alterations to a product that do not materially affect agreed specifications or the product's form, fit or function.

***The Greenteeth® are proudly manufactured in the USA by Green Manufacturing, Inc.***

Green Manufacturing, Inc.  
9650 Packard Rd  
Morenci, MI 49256  
Phone 800.473.3683 • Fax 517.458.1550



# MATERIAL SAFETY DATA SHEET

## I - PRODUCT IDENTIFICATION

**Trade Name:** Tungsten Carbide **Chemical Family:** Refractory Metal Alloy

**Chemical Formula:** WC **CAS#:** 12070-12-1

## II - HAZARDOUS INGREDIENTS

**Hazardous Components % OSHA/PEL ACGIH/TLV Sec. 302 Sec. 304 Sec. 313**

Tungsten Carbide 0-100 N/E N/E No No No

Tungsten compounds 0-100 5 mg/m<sup>3</sup> C - 1 0 mg/m<sup>3</sup> No No No

**HM IS Ratings (0-4): Health:** 3 **Flammability:** 0 **Reactivity:** 0

**HM IS Protective Equipment:** H: glasses, gloves, clothing, combo respirator

## III - PHYSICAL DATA

**Boiling Point:** 6000 oC **Melting Point:** 2820 - 2940 oC

**Evaporation Rate:** N/A % **Volatiles:** N/A

**Solubility in H<sub>2</sub>O:** Insoluble **Vapor Pressure:** N/A

**Vapor Density:** N/E **Specific Gravity:** 13.6 gm/cc at 18 oC

**Appearance and Odor:** Grey to black powder, odorless **Molecular Weight:** 195.86

## IV - FIRE AND EXPLOSION HAZARDS DATA

**Flash Point:** N/A **Flammability:** Non-Flammable

**Explosive Limits: Lower:** N/A **Upper:** N/A

**Extinguishing Media:** Use suitable extinguishing media for surrounding materials and type of fire.

**Special Fire Fighting Procedures:** Firefighters must wear full face, self-contained breathing apparatus with full protective clothing to prevent contact with skin and eyes. Fumes from fire are hazardous. Isolate runoff to prevent environmental pollution.

**Unusual Hazard:** Dusts may present a fire or explosion hazard under rare favoring conditions of particle size, dispersion, and strong ignition source. However, this is not expected to be a problem under normal handling conditions.

## V - HEALTH HAZARD INFORMATION

**Routes of Entry:** Inhalation, ingestion, skin or eye contact (for dusts, mists, powder, and fume).

**Effects of Overexposure:** Industrially tungsten does not constitute an important health hazard. Exposure is related chiefly to the dust arising out of the crushing and milling operations. Chronic inhalation of the dust may cause lung damage in humans. Heavy exposure to the dust or the large amounts of the soluble compounds produces changes in body weight, behavior, blood cells, choline esterase activity and sperm in experimental animals.

### **Acute Effects:**

**Inhalation:** Toxic by inhalation. May cause irritation to the mucous membranes, coughing, dyspnea, soreness in the chest, weight loss, hemoptysis, bronchitis, asthma, pulmonary fibrosis and radiological changes in the lungs.

**Ingestion:** May cause irritation to the gastrointestinal tract and diarrhea.

**Skin:** May cause irritation.

**Eye:** May cause irritation.

### **Chronic Effects:**

**Inhalation:** May cause damage to the lungs.

**Ingestion:** No chronic health effects recorded.

**Skin:** May cause dermatitis, sensitization and eczema.

**Eye:** May cause conjunctivitis.

**Medical Conditions Generally Aggravated by Exposure:** Pre-existing respiratory and skin disorders.

**Target Organs:** May affect the respiratory system.

**Carcinogenicity:** NTP: No IARC: No OSHA: No

**EMERGENCY AND FIRST AID PROCEDURES:**

**INHALATION:** Remove victim to fresh air. Keep warm and quiet, give oxygen if breathing is difficult and seek medical attention.

**INGESTION:** If conscious, give 1-2 glasses of milk or water and induce vomiting (Never induce vomiting or give anything by mouth to an unconscious person). Seek medical attention.

**SKIN:** Remove contaminated clothing from affected area, brush material off skin. Wash affected area with mild soap and water. Seek medical attention if symptoms persist.

**EYE:** Flush eyes with lukewarm water, lifting upper and lower eyelids, for at least 15 minutes. Seek medical attention if symptoms persist.

**VI - REACTIVITY DATA**

**Stability:** Stable

**Conditions to Avoid:** None

**Incompatibility (Material to Avoid):** Chlorine, fluorine, nitrogen dioxide, nitrous oxide, iodine pentafluoride and lead oxide.

**Hazardous Decomposition Products:** None recorded.

**Hazardous Polymerization:** Will not occur

**VII - SPILL OR LEAK PROCEDURES**

**Steps to Be Taken in Case Material Is Released or Spilled:** Wear appropriate respiratory and protective equipment specified in Section VIII. Isolate spill area and provide ventilation. Vacuum up spill using a high efficiency particulate absolute (HEPA) air filter and place in a closed container for proper disposal. Take care not to raise dust.

**Waste Disposal Method:** Dispose of in accordance with all local, state, and federal regulations.

**VIII - SPECIAL PROTECTION INFORMATION**

**Respiratory Protection:** NIOSH approved dust, mist, and vapor cartridge respirator.

**Ventilation:** Use local exhaust ventilation which is adequate to limit personal exposure to airborne dust levels which do not exceed the appropriate PEL or TLV. If such equipment is not available, use respiratory protection as specified above.

**Protective Gloves:** Rubber gloves.

**Eye Protection:** Safety glasses.

**Other Protective Clothing or Equipment:** Protective gear suitable to prevent contamination.

**IX - SPECIAL PRECAUTIONS**

**Precautions to Be Taken in Handling and Storage:** Store in a tightly sealed container in a cool, dry, well-ventilated area. Wash thoroughly after handling.

**Other Precautions:** Implement engineering and work practice controls to reduce and maintain concentration of exposure at low levels. Use good housekeeping and sanitation practices. Do not use tobacco or food in work area. Wash thoroughly before eating or smoking. Do not blow dust off clothing or skin with compressed air.

The above information is believed to be correct, but does not purport to be all inclusive and shall be used only as a guide. Green Manufacturing, Inc. shall not be held liable for any damage resulting from handling or from contact with the above product.